

Continental

Refrigerator

GRIDDLE STAND FREEZERS



DL2GF-SS



DL1GF-SS

Standard Features

- Modern State-of-the-Art Styling
- Performance Rated Refrigeration System Utilizing Environmentally Safe R-404A Refrigerant
- Automatic, Energy Saving, Non-Electric Condensate Disposal System
- High Density, Non-CFC Polyurethane Foamed-In-Place Insulation
- Easily Accessible and Serviceable Front Slide-Out Condensing Unit
- Stainless Steel Exterior and Interior
- Plasticized Fin Coil
- Capillary Dial Thermometer
- Anti-Sweat Drawer Heaters
- Chrome-Plated Hardware
- Heavy-Duty Diecast Flowline Handle
- Heavy Gauge (20), Reinforced Stainless Steel Finished Work Top with Drip Guard, Marine Edge
- One Piece Snap-In Magnetic Gaskets
- Easy Glide Drawes
- Heavy Duty Drawer Track
- Adjustable 6" Stainless Steel Legs

Models Available

- DL1GF-SS
- DL2GF-SS

Optional Features & Accessories

- Heavy-Duty Casters
- Remote Models
- Stainless Steel Pans
- Special Electrical Requirements
- Digital Thermometer

Utilizing Environmentally Safe, CFC-free R-404A Refrigerant



Griddle Stand Freezers

SPECIFICATIONS

DIMENSIONAL DATA

	DL1GF-SS One Section		DL2GF-SS Two Section	
	Self-Contained	Remote	Self-Contained	Remote
Net Capacity (cu. ft.)	6.0	6.0	12.0	12.0
Width, Overall (in.)	50 ³ / ₄	37 ⁵ / ₈	76 ³ / ₈	63 ¹ / ₄
Depth, Overall (incl. Hdls.) (in.)	35	35	35	35
Depth, Body Only (Less Door(s))(in.)	33 ⁵ / ₈	33 ⁵ / ₈	33 ⁵ / ₈	33 ⁵ / ₈
Height, Overall (incl. 6" Legs) (in.)	26	26	26	26
Drawers (Std.)	2	2	4	4
12"x20" Pans (Not Furnished)	4	4	8	8

REFRIGERATION DATA

Condensing Unit Size (H.P.)	1/4	-	1/3	-
Capacity (BTU/HR)*	1250	1250	1590	1590

ELECTRICAL DATA

Cabinet Specifications	115/60/1	115/60/1	115/60/1	115/60/1
Condensing Unit Specs.	115/60/1	-	115/60/1	-
Cabinet Amperes	1.6	1.6	1.6	1.6
Total Amperes	6.0	1.6	7.6	1.6
Power Supply Cord 10 Ft.	Yes	Yes	Yes	Yes

SHIPPING DATA

Height-crated (in.)	44	44	44	44
Width-crated (in.)	65	65	109	109
Depth-crated (in.)	41	41	41	41
Volume-crated (cu.ft.)	61	61	103	103
Weigh-crated (lbs.)	450	390	580	520

* Rating @ -15°F Evaporator, 90° Ambient

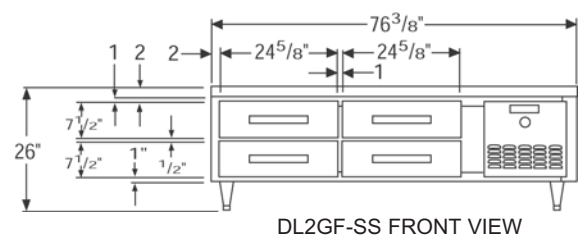
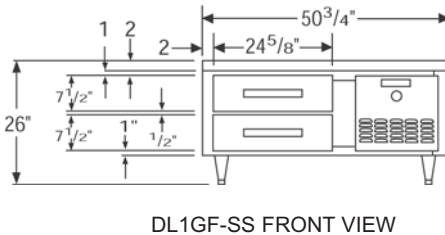
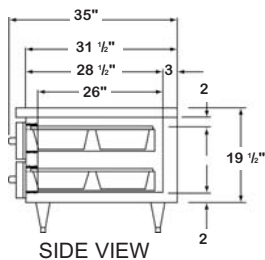

Continental

Refrigerator

A Division of National Refrigeration & A/C Products, Inc.
 539 Dunksferry Road Bensalem, PA 19020
 (800) 523-7138 Fax: (215) 244-9579
www.continentalrefrigerator.com